



## Model Number

NJ15+U1+DW1-100

## Features

- Rotational speed controller
- 15 mm flush
- Start-up override time = approx. 30 s
- Up to 100 Hz

## Accessories

### MH 04-2681F

Mounting aid for VariKont, +U1+ and +U9\*

### V1-M20-80

Receptacles, M12/M20; plastic version

### V1-G

Female connector, M12, 4-pin, field attachable

### V1-W

Female connector, M12, 4-pin, field attachable

## Technical Data

### General specifications

Switching element function	PNP NO contact
Frequency range	10 ... 100 Hz, adjustable
Rated operating distance	$s_n$ 15 mm
Installation	flush
Output polarity	DC
Assured operating distance	$s_a$ 0 ... 12.15 mm
Reduction factor $r_{AI}$	0.4
Reduction factor $r_{CU}$	0.3
Reduction factor $r_{304}$	0.85

### Nominal ratings

Operating voltage	$U_B$ 15 ... 60 V DC
Reverse polarity protection	reverse polarity protected
Short-circuit protection	pulsing
Voltage drop	$U_d$ $\leq 2$ V
Operating current	$I_L$ 0 ... 100 mA
No-load supply current	$I_0$ $\leq 25$ mA
Switching state indicator	LED 1: yellow
Damping indicator	LED 2: yellow

### Functional safety related parameters

MTTF <sub>d</sub>	820 a
Mission Time ( $T_M$ )	20 a
Diagnostic Coverage (DC)	0 %

### Ambient conditions

Ambient temperature	-25 ... 70 °C (-13 ... 158 °F)
---------------------	--------------------------------

### Mechanical specifications

Connection type	screw terminals
Information for connection	A maximum of two conductors with the same core cross-section may be mounted on one terminal connection! tightening torque 1.2 Nm + 10 %
Core cross-section	up to 2.5 mm <sup>2</sup>
Minimum core cross-section	without wire end ferrule 0.5 mm <sup>2</sup> , with connector sleeves 0.34 mm <sup>2</sup>
Maximum core cross-section	without wire end ferrule 2.5 mm <sup>2</sup> , with connector sleeves 1.5 mm <sup>2</sup>
Housing material	PBT
Sensing face	PBT
Degree of protection	IP67

### Compliance with standards and directives

Standard conformity	
Standards	EN 60947-5-2:2007 IEC 60947-5-2:2007

### Approvals and certificates

UL approval	cULus Listed, General Purpose
CSA approval	cCSAus Listed, General Purpose
CCC approval	Certified by China Compulsory Certification (CCC)

## Dimensions

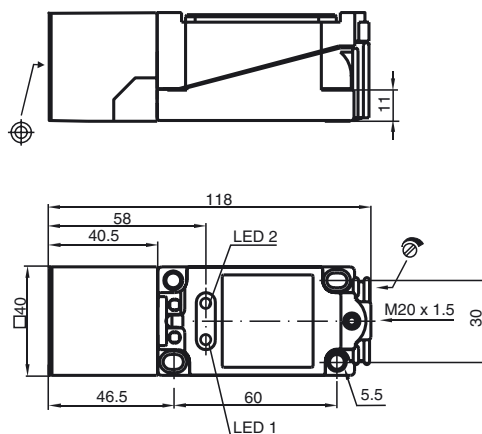

## Electrical Connection

