



Model Number

NJ15+U1+DW1-10

Features

- Rotational speed controller
- 15 mm flush
- Start-up override time = approx. 30 s

Accessories

MH 04-2681F

Mounting aid for VariKont, +U1+ and +U9*

V1-M20-80

Receptacles, M12/M20; plastic version

V1-G

Female connector, M12, 4-pin, field attachable

V1-W

Female connector, M12, 4-pin, field attachable

Technical Data

General specifications

| | |
|----------------------------|-------------------------|
| Switching element function | PNP NO contact |
| Frequency range | 1 ... 10 Hz, adjustable |
| Rated operating distance | s_n 15 mm |
| Installation | flush |
| Output polarity | DC |
| Assured operating distance | s_a 0 ... 12.15 mm |
| Reduction factor r_{AI} | 0.4 |
| Reduction factor r_{CU} | 0.3 |
| Reduction factor r_{304} | 0.85 |

Nominal ratings

| | |
|-----------------------------|----------------------------|
| Operating voltage | U_B 15 ... 60 V DC |
| Reverse polarity protection | reverse polarity protected |
| Short-circuit protection | pulsing |
| Voltage drop | U_d ≤ 2 V |
| Operating current | I_L 0 ... 100 mA |
| No-load supply current | I_0 ≤ 25 mA |
| Switching state indicator | LED 1: yellow |
| Damping indicator | LED 2: yellow |

Functional safety related parameters

| | |
|--------------------------|-------|
| MTTF _d | 820 a |
| Mission Time (T_M) | 20 a |
| Diagnostic Coverage (DC) | 0 % |

Ambient conditions

| | |
|---------------------|--------------------------------|
| Ambient temperature | -25 ... 70 °C (-13 ... 158 °F) |
|---------------------|--------------------------------|

Mechanical specifications

| | |
|----------------------------|---|
| Connection type | screw terminals |
| Information for connection | A maximum of two conductors with the same core cross-section may be mounted on one terminal connection! tightening torque 1.2 Nm + 10 % |
| Core cross-section | up to 2.5 mm ² |
| Minimum core cross-section | without wire end ferrule 0.5 mm ² , with connector sleeves 0.34 mm ² |
| Maximum core cross-section | without wire end ferrule 2.5 mm ² , with connector sleeves 1.5 mm ² |
| Housing material | PBT |
| Sensing face | PBT |
| Degree of protection | IP67 |

Compliance with standards and directives

| | |
|---------------------|---|
| Standard conformity | |
| Standards | EN 60947-5-2:2007 IEC 60947-5-2:2007 |

Approvals and certificates

| | |
|--------------|---|
| UL approval | cULus Listed, General Purpose |
| CSA approval | cCSAus Listed, General Purpose |
| CCC approval | Certified by China Compulsory Certification (CCC) |

Dimensions

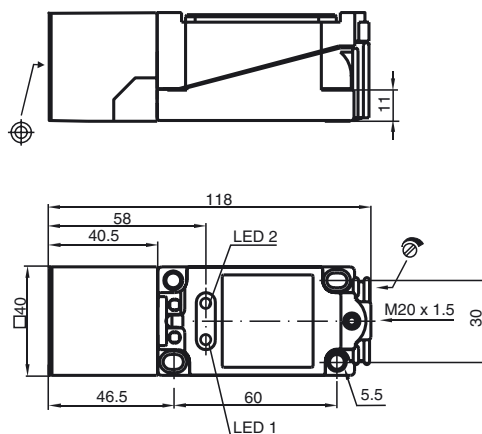

Electrical Connection

