



## Model Number

**NBB10-30GM50-E0-V1**

## Features

- **Basic series**
- **10 mm flush**

## Accessories

### BF 30

Mounting flange, 30 mm

### EXG-30

Quick mounting bracket with dead stop

### V1-G

Female connector, M12, 4-pin, field attachable

### V1-W

Female connector, M12, 4-pin, field attachable

### V1-G-2M-PUR

Female cordset, M12, 4-pin, PUR cable

### V1-W-2M-PUR

Female cordset, M12, 4-pin, PUR cable

## Technical Data

### General specifications

Switching function	Normally open (NO)
Output type	NPN
Rated operating distance	$s_n$ 10 mm
Installation	flush
Output polarity	DC
Assured operating distance	$s_a$ 0 ... 8.1 mm
Reduction factor $r_{AI}$	0.3
Reduction factor $r_{CU}$	0.3
Reduction factor $r_{304}$	0.8
Output type	3-wire

### Nominal ratings

Operating voltage	$U_B$ 10 ... 30 V
Switching frequency	$f$ 0 ... 200 Hz
Hysteresis	$H$ typ. 5%
Reverse polarity protection	reverse polarity protected
Short-circuit protection	pulsing
Voltage drop	$U_d$ $\leq 3$ V
Operating current	$I_L$ 0 ... 200 mA
Off-state current	$I_r$ 0 ... 0.5 mA typ. 0.1 $\mu$ A at 25 °C
No-load supply current	$I_0$ $\leq 20$ mA
Switching state indicator	Multihole-LED, yellow

### Functional safety related parameters

MTTF <sub>d</sub>	1374 a
Mission Time ( $T_M$ )	20 a
Diagnostic Coverage (DC)	0 %

### Ambient conditions

Ambient temperature	-25 ... 70 °C (-13 ... 158 °F)
---------------------	--------------------------------

### Mechanical specifications

Connection type	Connector plug M12 x 1, 4-pin
Housing material	brass, nickel-plated
Sensing face	PBT
Degree of protection	IP67

### Compliance with standards and directives

Standard conformity	
Standards	EN 60947-5-2:2007 EN 60947-5-2/A1:2012 IEC 60947-5-2:2007 IEC 60947-5-2 AMD 1:2012

### Approvals and certificates

UL approval	cULus Listed, General Purpose
CSA approval	cCSAus Listed, General Purpose
CCC approval	CCC approval / marking not required for products rated $\leq 36$ V

## Dimensions

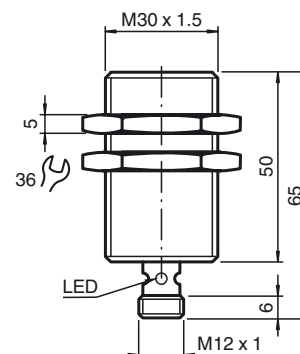

## Electrical Connection

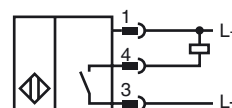



Pinout

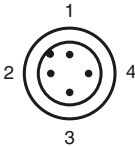

Wire colors in accordance with EN 60947-5-2

1	BN	(brown)
2	WH	(white)
3	BU	(blue)
4	BK	(black)